

ACCESS ROAD

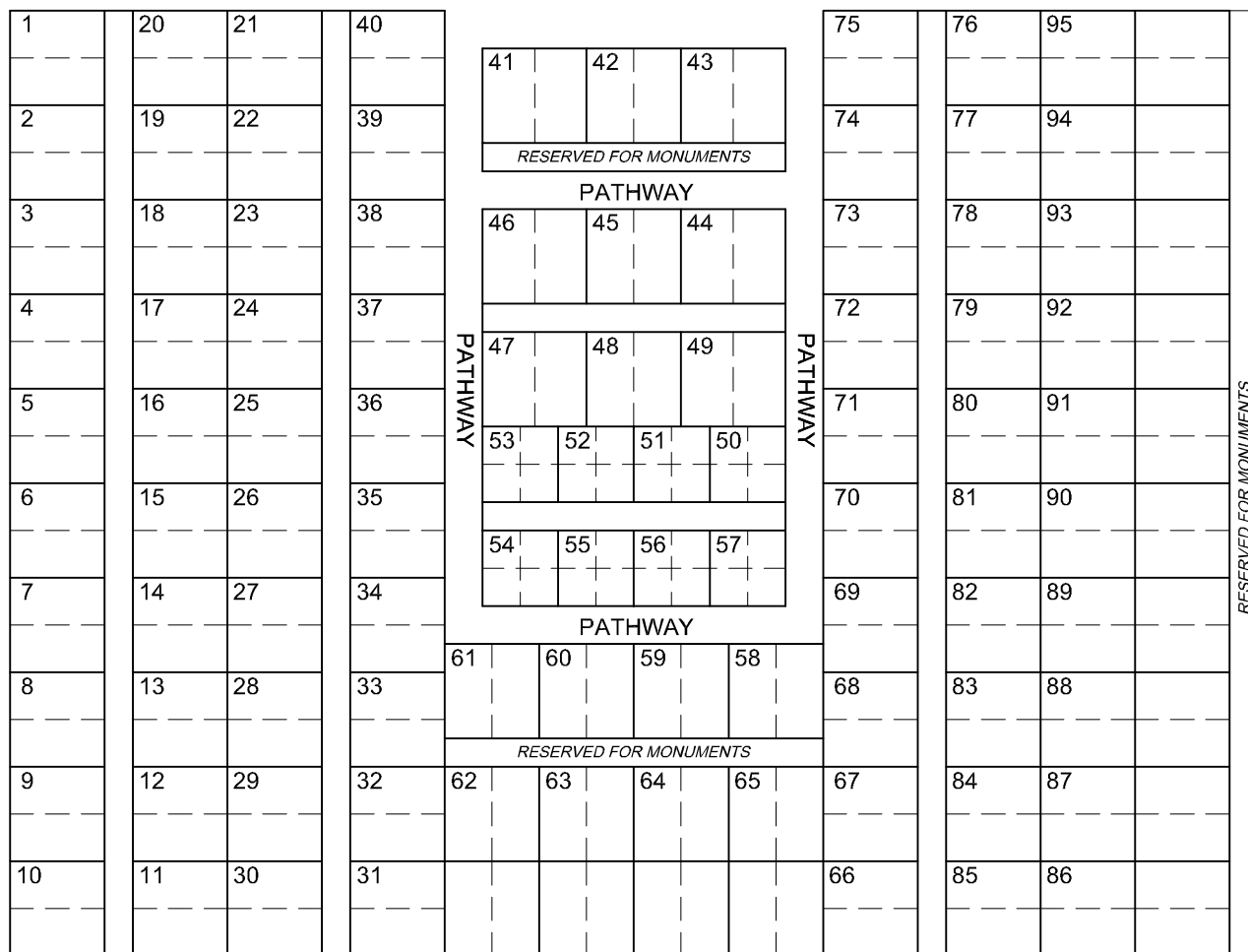

NOTE:  
 A TYPICAL DOUBLE LOT IS 10'X10', WITH THE EXCEPTION  
 OF LOTS 134 - 141, AND 50 - 57, WHICH ARE 8'X8'.



**MILFORD CEMETERY  
 SECTION 'E'  
 MILFORD, MAINE**

SCALE: 1" = 20'

PREPARED BY



24 FEBRUARY 2012